

MANUAL

621-443, Dancer II
Dual, ww, wh, go, 501x450x498cm



www.mk-illumination.com

On the Dancer 2, there are seven segments:

- The woman's body and man body- ww
- Her dress top- dual
- Her dress lower part - dual
- The left and outer wing of the woman- dual
- The right outer wing of the woman - dual
- His Jacket - dual
- His trousers - dual



pair qx connectors to each other
with the same colour mark

first assemble the top body with the hands
then let him lie down on the floor
and mount the men's trousers
tighten all screws properly and lift him up.

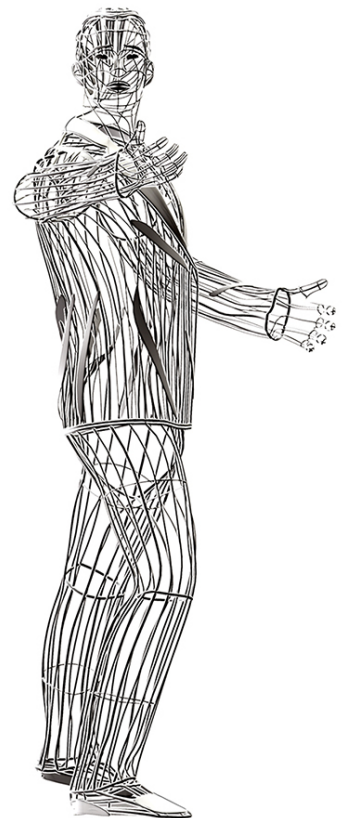
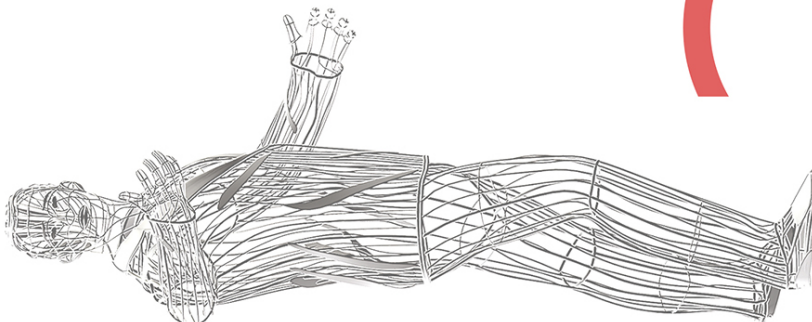
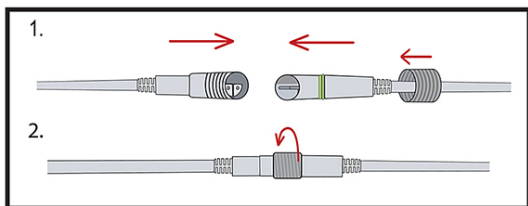
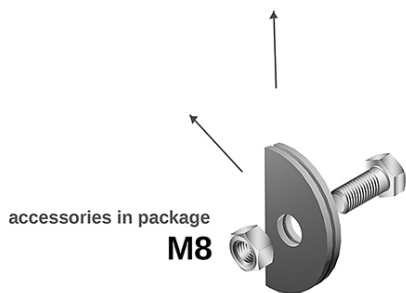

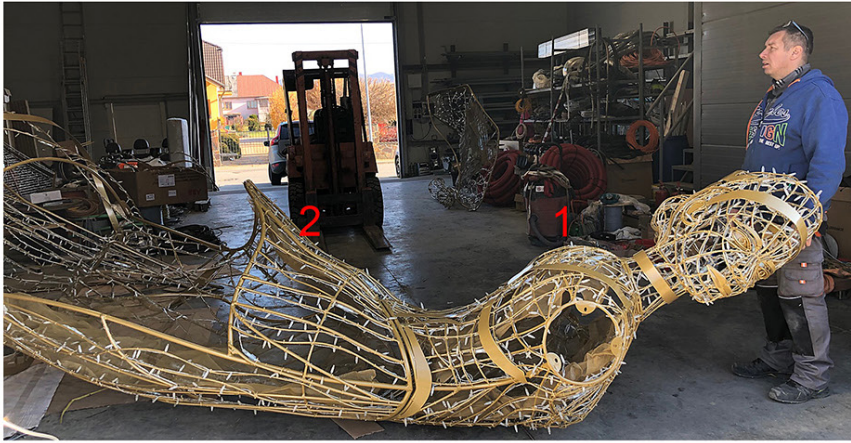

accessories in package

M8

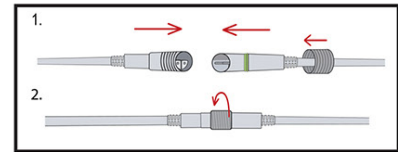

assemble the first and the second part together,
 don't mount her hands yet !!!
 lift the figure up and assemble the third part,
 then move the lady figure closer to the man figure



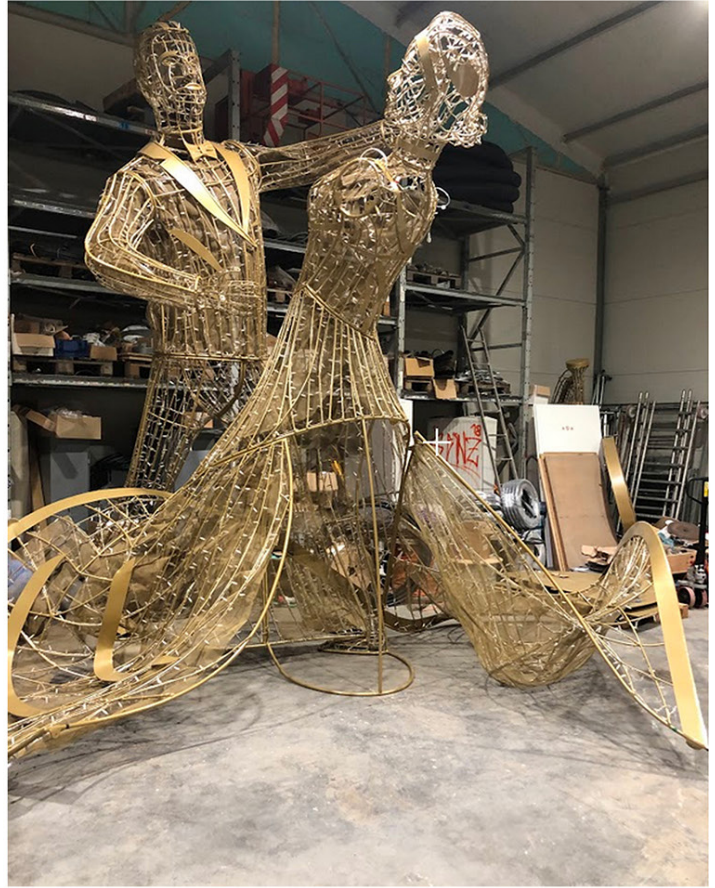

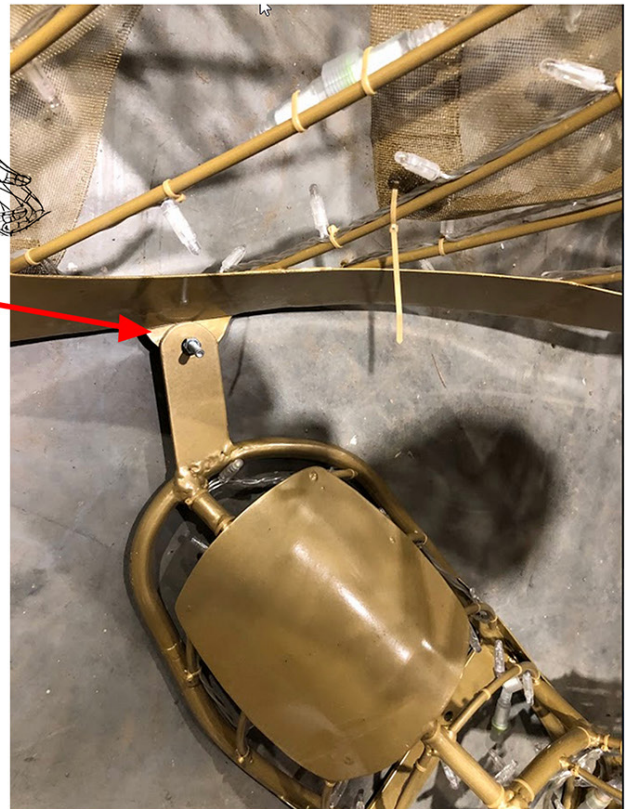
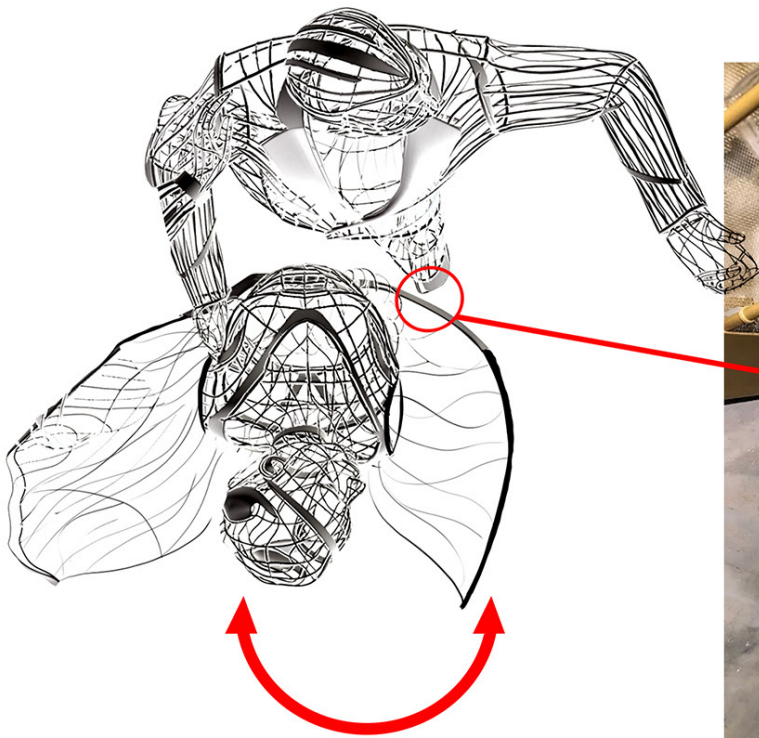

mount the right and left side of the dress marked with the same number

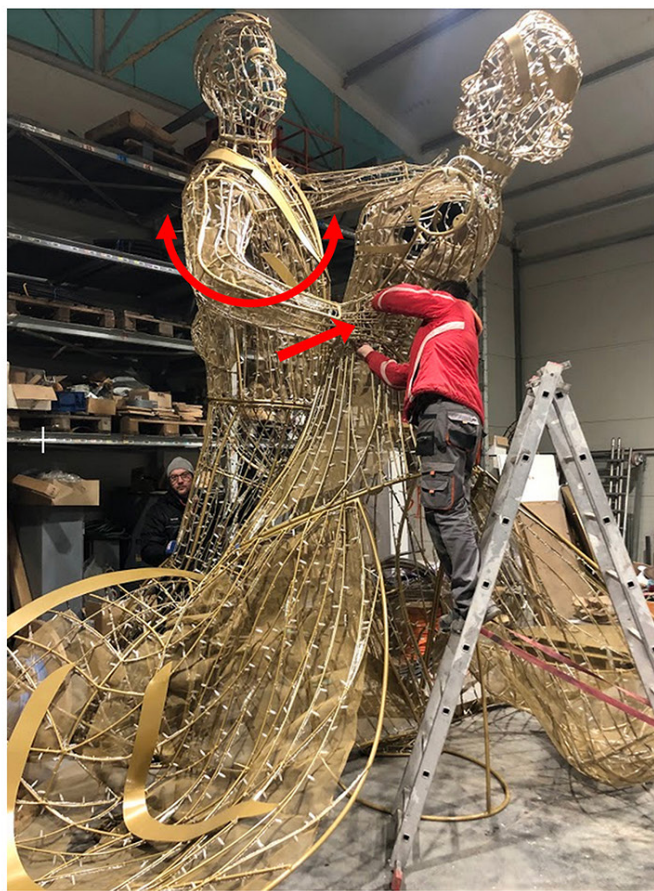

it needs to be adjusted a bit

adjust his hand to her body it needs maneuvering like man rotation and patience



<p>ACCESSORIES (not supplied)</p> 	<p>- Crane - Ladder</p>
--	-----------------------------

now is the time to mount her hands and again takes a little maneuvering



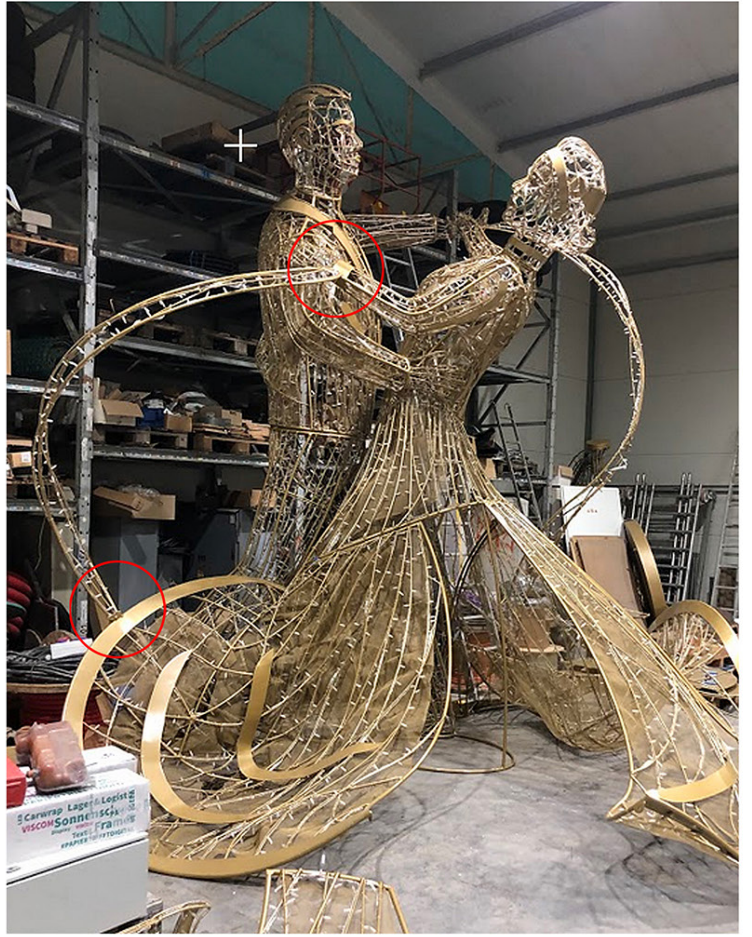

mount the wings ribbons 2 pieces on both sides of her dress by numbers.

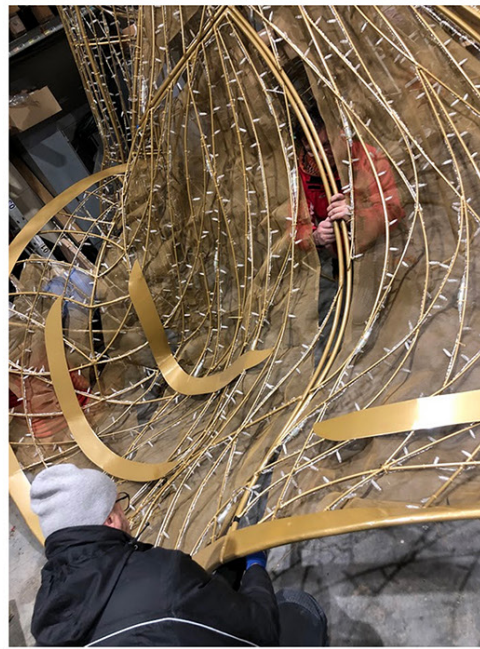

as the last to close the dress from inside, don't stay there forever

Figures must be fixed to the ground
with crews M8
inside the feet of a man and
at the bottom of her clothes
also possibility using
steel wire 3mm thickness and
at 60 angle

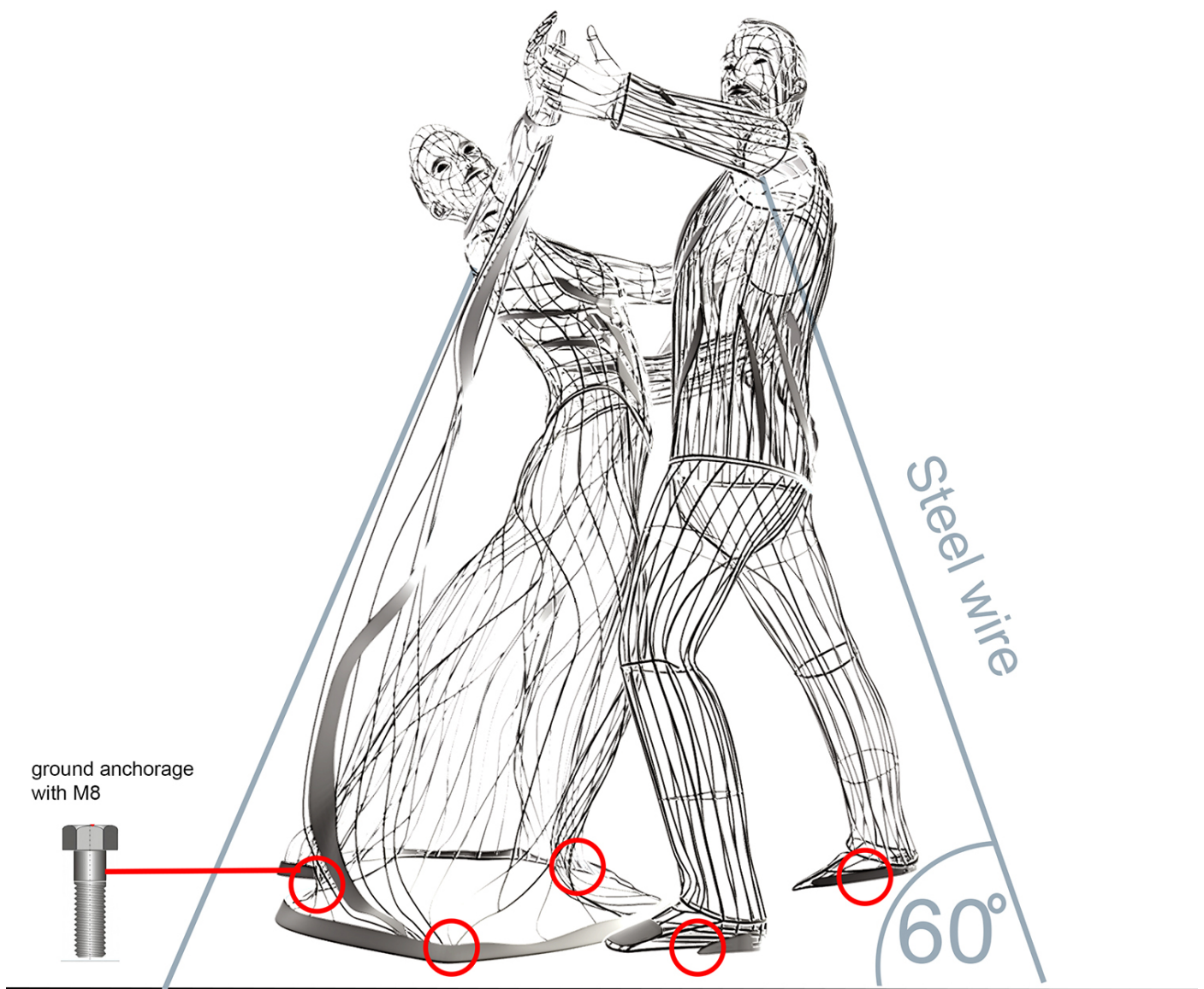

steel wire is not part of the package